



Price Guide £275,000

Houseboat Honalee, Chichester Marina, Birdham, Nr Chichester, PO20 7EJ







1



1



1



EPC



A

Houseboat Honalee is modular in style, eco-friendly and well insulated, constructed with cedar clad Structural Insulated Panels (SIPS) and a concrete floating hull built and imported from the Netherlands. The bespoke architect design with unique features, includes bright, lofty, open plan well appointed accommodation with required planning permissions, plus underfloor heating, mechanical ventilation/heat recovery (MVHR) and insulated hull storage. Large windows overlook the canal and there are double bedroom and bathroom quarters, with a useful mezzanine area providing additional storage. There is also access to an upper deck area maximizing useful living and socialising space on board.

The owners can monitor and control a number of features remotely making this an energy efficient home, with input from solar power panels and full Fibre Broadband connectivity. Rarely available full residential mooring as the houseboat can be used all year round as the owners principal home or personal holiday home.

Situated outside is a small cedar clad summerhouse which could provide home office space/store with electricity and broadband connection available. The houseboat is conveniently located with easy access from the nearby pedestrian foot bridge over the canal.

At the time Honalee was built and installed on the canal, she had a T.V. debut starring in 'My Floating Home'. Series 1. We highly recommend arranging a viewing to fully appreciate this amazing home on water.

NOTE: The houseboat is purchased outright. The houseboat owner will be required to enter into a new yearly berthing licence agreement to moor the vessel on the canal with Premier Marinas - subject to their terms and conditions.

The 12 month berthing fee agreement is charged currently at £7,360 from 01/04/2023. A garden licence is also required currently £150 p.a.

Electricity is via metered supply from Premier Marinas and charged on a per unit basis. Drinking water and waste water is supplied and managed via the Marina facilities and is covered within the the annual berthing fee.

There is un-allocated parking in the marina areas and access to laundry and shower facilities on the marina site, if required.

Please note the canal path areas running alongside the houseboats are private areas and viewing is strictly by prebooked and accompanied appointment only - please call Baileys on 01243 672217 to arrange.

The purchase of the houseboat is a cash purchase only and we shall require proof of funding, before arranging any appointments to view.

Virtual viewing link: <https://my.matterport.com/show/?m=Co72eFdFKmC>



















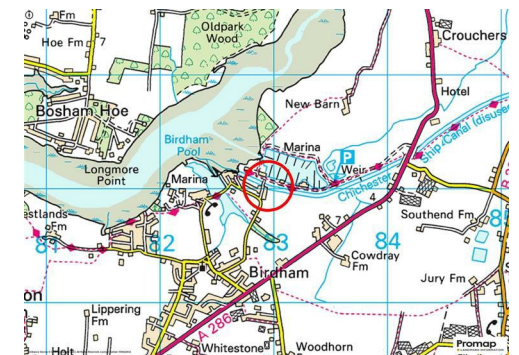



# Houseboat Honalee, Chichester Marina, PO20 7EJ

APPROXIMATE GROSS INTERNAL AREA = 635 SQ FT / 59.0 SQ M

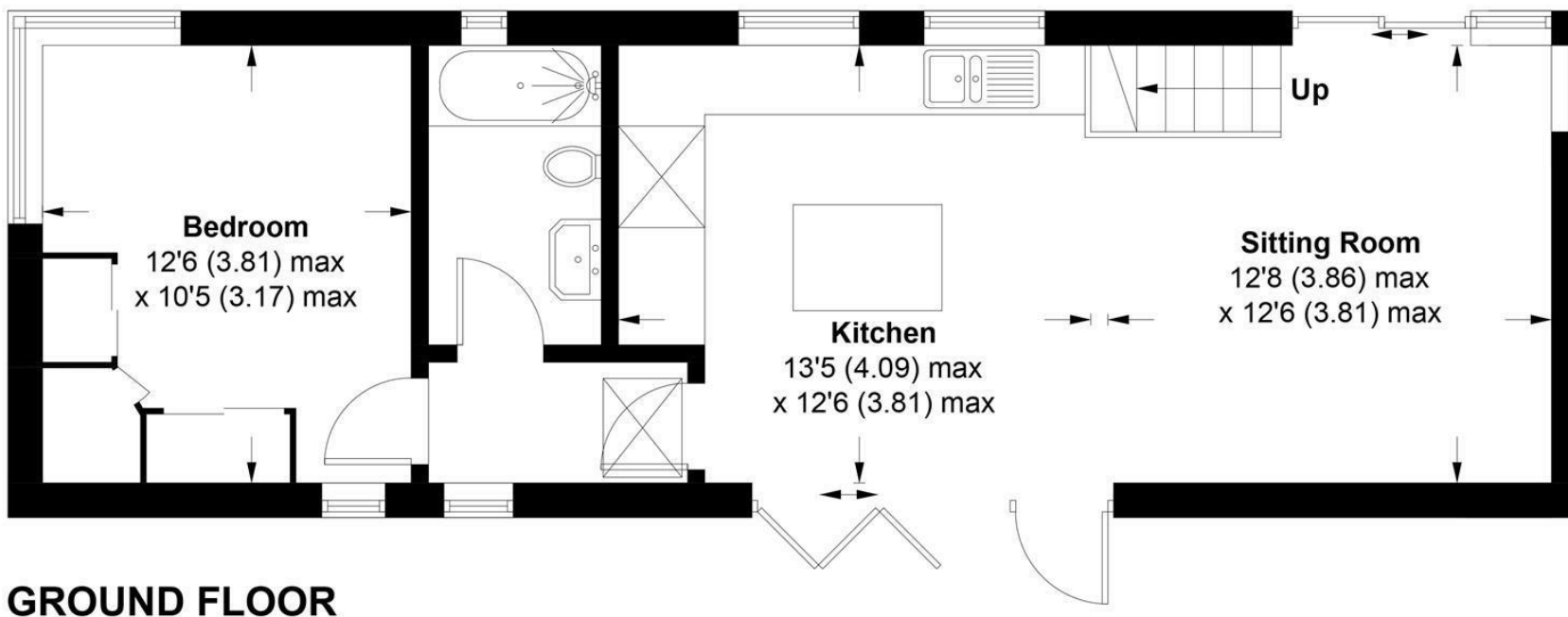

**GROUND FLOOR**

This plan is for layout guidance only. Not drawn to scale unless stated. Windows and door openings are approximate. Whilst every care is taken in the preparation of this plan, please check all dimensions, shapes and compass bearings before making any decisions reliant upon them. (ID1007360)

**Produced for Baileys Estate Agents**

Working in co-operation with the owners we have tried to be accurate and informative in the presentation of our property details. Baileys would advise that no representations or warranties are made or given in respect of the condition of any items mentioned in the Sales Particulars. If however, you are not sure about a particular point please contact us to verify the information. This is especially important if viewing the property involves travelling some distance.